

42

YACHT



Features

- An exceptional performing and seaworthy hull shape providing best in class stability and comfort
- Expansive outdoor living and entertaining spaces with luxurious interior styling and amenities
- Plenty of sun coverage via fiberglass hardtop with 316L polished stainless steel supports on flybridge
- Direct bow access from central steps leading from flybridge to bow area
- FUSION audio system with Bluetooth and eight (8) Fusion speakers and 4 zone sound control
- Optional interior helm station for added comfort during inclement weather
- For overnighting, premium comforts are provided by two (2) double berth cabins each with their individual walk in toilet with separate shower

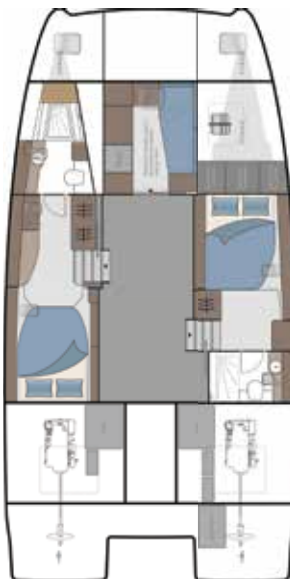
STANDARD
FLYBRIDGESTANDARD
MAIN DECKSTANDARD
2 CABIN + UTILITY

SPECIFICATIONS

LENGTH: 12.64 M • 41' 6"
OVERALL.

BEAM: 6.4M • 21' 0"

HEIGHT: 5.49 M • 18' 0"
ABOVE WATERLINE WITH HARDTOP (EXCLUDING ELECTRONICS)

DRAFT: 1.10 M • 3' 7"
WITH SACRIFICIAL KEEL INSTALLED.

LIGHT DISPLACEMENT:
15,700 KG • 34,168 LB

LOADED DISPLACEMENT:
19,000 KG • 41,895 LB

FOILS: Optional.



ACCOMMODATIONS

SLEEPS UP TO: 8

MAXIMUM PASSENGERS: 24

CABINS: 2 • 3 • 4

HEADS WITH SHOWERS: 2 • 3

UTILITY ROOMS: 1



TANKAGE

FUEL: 1,000 L • 264 GAL

WATER: 460 L • 132 GAL

HOLDING: 160 L • 42 GAL



PROPULSION

STANDARD:
2x D4 230 HP Volvo Penta

OPTIONAL:
2x D4 300 HP Volvo Penta

2x D4 320 HP Volvo Penta

2x 370 HP Yanmar



CE CERTIFICATION

A (OCEAN): 8

B (OFFSHORE): 12

C (COASTAL): 16

D (INLAND): 24

All specifications and options are subject to change by Sino Eagle Yachts at their sole discretion. Performance is purely indicative and not a contractual commitment. Performance is subject to many variances outside the control of Sino Eagle Yachts. Specifications and graphics in this brochure are non-binding and customer must enter into contractual agreement with the Dealer or Agent of Record. Actual color samples may vary slightly from digital representation.

OUT THERE STARTS HERE™

aquilaboats.com

Updated 8.15.25

Construction

- Resin infused vinyl ester hull, deck, and bulkhead construction creating high strength and stiffness
- Vinyl ester resin with excellent corrosive and water resistant properties
- Core materials vary in density dependent on loads
- Water tight bulkheads fore and aft
- Bulbous bows separately molded and attached to each bow
- Windows in hull and deck high quality PMMA/Acrylic material
- Custom built stainless steel salon and flybridge support structure

Interior Layout

- Two (2) cabins with double berths and private heads with walk in showers and fresh water electric toilets
- Utility cabin with storage cupboards and single bunk/sofa. Reduced headroom to maintain panoramic salon view.
- Large salon area with comfortable U-Shaped seating
- Large galley area with common household amenities

Hull and Deck Features

- Eight (8) opening deck hatches carefully positioned to enhance ventilation in cabins
- Six (6) opening port lights installed in hull side windows and forward salon windows
- Removeable mosquito screens for hull side portholes
- Custom built PVC rubrail with 316L stainless steel insert offering all round protection
- Solid custom deck railing in 316L stainless steel
- 2x comfortable and protected bow seats integrated into deck railing
- 10x mooring cleats in solid 316L polished stainless steel thru bolted
- Deck fill plates in 316L stainless steel: water (2); fuel (2); waste (2)
- Bow roller for secondary anchor – 316L polished stainless steel
- Anchor locker with 1000 watt windlass, handheld remote control with chain lock
- Primary anchor – 20 kg/44 lb Delta with 150 ft 5/16" chain with shackles and bridle system
- Well placed ergonomic handrails in 316L stainless steel ensuring secure movement onboard
- Forward access steps from flybridge to bow with 316L polished stainless steel support structure
- Ergonomic transom steps for easy boarding and comfortable lounging off stern
- LED navigation lights – running and anchoring lights
- Engine ventilation intakes with FRP cowling cover
- Swim ladder – hidden Aquila slide out stainless steel with steps and handrail for easy boarding
- Large in deck storage area accessed from starboard side deck

- Aft cockpit with hinging window and door opening to galley
- Aft cockpit seating with table
- LED deck courtesy lights located at transom, cockpit, and flybridge
- Large spacious foredeck with cushions for sunbathing



Flybridge

- Expansive FRP hard top with stainless steel supports and overhead lighting
- Access to flybridge from aft stairway and forward bow steps
- Main access from aft cockpit via integrated molded steps
- Ergonomic positioned handrail for safe access from aft cockpit
- Forward flybridge access via center forward bow steps with built in stainless steel handrail for safety
- Flybridge stainless steel guardrails with acrylic wind protection inserts
- Electronic engine double lever throttle and gearshift control
- Hydraulic steering with variable position steering wheel
- LCD engine display at helm
- Compass at helm station
- Four (4) Fusion marine speakers mounted in hard top ceiling
- Spacious comfortable helm seat for two (2) people with upholstered seat, backrest, and flip bolsters
- Comfortable port side seating adjacent to helm station
- Flybridge table comfortably seats six (6)
- Upholstered flybridge cushions with backrest
- Wet bar behind helm station incorporating Corian work surface, sink with hot and cold faucet
- Integrated hinged fiberglass cover for wet bar area
- Large storage area under wet bar with two (2) access doors
- Lifejacket and safety gear storage under flybridge seats
- Cup holders located in various areas around flybridge

Engine Room

- Custom designed engine exhaust to reduce engine emission noise
- Automatic fire suppression heat activated system with alarm monitors at helm station

- Start/stop switches at helm station
- Engine room bulkhead insulation – 50 mm flame retardant polyurethane foam covered metalized polyester film
- Engine room lighting
- Automatic bilge pump in each engine room
- Excellent all round engine and systems access for ease of maintenance
- Two (2) hydraulic steering cylinders

Underwater Gear

- Propeller tunnels for reduced draft and maximum efficiency
- Four (4) blade bronze propellers
- Machined stainless steel propeller shafts with rope cutter installed on each shaft
- Rudders and tiller arm in 316L stainless steel with FRP tube
- Shut off valves on all salt water intakes in engine rooms
- Sea water intake strainers
- Watertight self aligning dripless shaft seal with 316L stainless steel housing
- Extended bronze P-bracket for maximum propeller protection
- Sacrificial skeg forward of drive for added running gear protection
- Black antifouling paint on hull surface at and below waterline



Technical Features

- Bilge pump warning
- Instrument panels including LCD engine display at helm
- Hydraulic steering system with tilt helm steering wheel
- Custom Aquila stainless steel steering wheel

Salon

- Excellent all round visibility from salon seating
- Windows with external overhangs offers excellent visibility and reduced sunlight
- Tempered glass, hinged door, and window access to cockpit offers excellent ventilation and through flow
- Two (2) opening port lights in forward salon windows provide excellent ventilation
- Custom blinds fitted on salon outboard windows

- Overhead LED ceiling lights, LED mood lighting and LED courtesy lighting
- Paneled ceilings with LED accent lighting
- Cabinets and counter top on port side
- Settee seating U-shaped around salon table, six (6) seats
- Salon table which has ability to convert into comfortable single bed
- Upholstered cushions
- Two (2) Fusion speakers
- Synthetic wear resistant flooring offering maintenance free natural wood look

Galley

- Two (2) burner electrical induction cooktop
- Convection microwave
- Refrigerator/freezer (DC powered)
- Stainless steel sink with single lever variable temperature faucet
- Storage cupboards and drawers offering ample storage for all galley accessories
- Durable stain-resistant Corian countertop
- Ample storage lockers on port side under Corian worktop surface
- Concealed garbage bin
- Overhead LED ceiling lights as well as mood lighting
- Synthetic wear resistant flooring offering maintenance free natural wood look

Staterooms

- Large windows throughout offering excellent views
- Dedicated hanging lockers
- Ample storage lockers including underneath beds
- Custom blinds fitted on cabin hull windows
- Concealed shade blind and insect screen on opening deck hatch where installed
- Overhead LED ceiling lighting and floor courtesy lighting
- Overhead LED reading lights
- Memory foam mattresses
- Synthetic wear resistant flooring offering maintenance free natural wood look
- Cabin door offering privacy
- Cabin Mattress Sizes:
 - Master: 59" W x 79" L (150 cm x 200 cm);
 - Stbd Guest Cabin: 59" W x 79" L (150 cm x 200 cm);
 - Mid Cabin: 32" W x 77" L (80 cm x 196 cm)

Utility Cabin & Storage

- Single bed/sofa with memory foam mattress (option to convert to double bed including direct access to designated head and shower area)
- Cabinetry storage to port side
- Sliding privacy door
- Designated area for optional washer/dryer
- Well ventilated with overhead deck hatch—also allows direct access to and from deck

Heads & Separate Shower Stalls

- Quiet electric fresh water flush toilet with large bowl and push button control in each bathroom
- Private door leading into cabin
- Opening deck hatch offering ample ventilation
- Opening port light in large window
- Stylish round wash basin with single lever variable temperature faucet
- Custom blinds
- Vanity lockers with mirrors
- Synthetic wear resistant flooring offering maintenance free natural wood look
- Separate shower stall with flexible shower faucet
- Acrylic door separating shower from the rest of the bathroom
- Automatic shower and sink drain via dedicated sealed sump box
- Overhead LED lighting
- Toilet roll holder

Navigation Area

- Ample navigation work surface for charts and books
- Dedicated electronics display panel offering easy access and visibility to electronic systems
- Multizone Fusion entertainment system master unit offering three (3) Fusion speakers and 4 zone control
- Light switch panel controlling all salon, galley, and aft cockpit lighting
- Remote battery switches for all onboard batteries

Water & Bilge System

- Fresh water pressure pump with accumulator tank offering equal water pressure throughout
- 40 L/ 10.6 gal hot water cylinder powered by engine heat exchangers and AC power
- Two (2) 230 L/ 60.8 gal water tanks
- Transom pull out shower mixer (hot/cold)
- Four (4) automatic 12v bilge pumps

Waste System

- Grey water from showers and sinks collected in two (2) sealed sump boxes with auto discharged overboard
- Two (2) 80 L/ 21 gal black water holding tanks discharged via deck pump out or electric overboard pumps

Electrical System

- Inverter/charger 12/110v 3000 VA or 12/230v 3000 VA (voltage dependent of boats destination)
- House batteries two (2) 200 Amp/Hour AGM in dedicated battery locker
- Dedicated 105 Amp/Hour engine start batteries
- AC power supplied by one (1) 50 Amp 125/250v shore power cable
- Dedicated circuit breaker switches for all high load components
- Galvanic isolator protector system

Fuel System

- Diesel fuel system with water separation filters
- Two (2) x 250L (66 Gal) dedicated fuel tanks in each hull. Total fuel capacity 1,000L (264 Gal).
- Fuel filters for each engine
- Aluminum fuel tanks with safety shut off valves

Safety

- Automatic fire suppression heat activated system with alarm monitors at helm station
- Mooring kit including six (6) fenders and six (6) mooring ropes

Optional Configuration

OPTIONAL
MAIN DECK

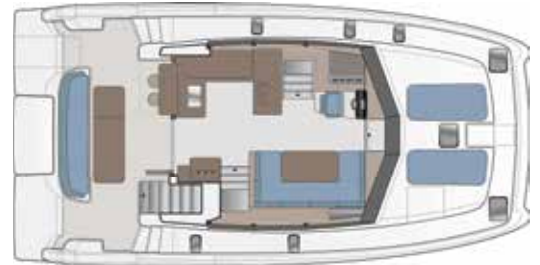

OPTIONAL
3 CABIN



OPTIONAL
4 CABIN

